

Level Detection Sensor with Float

- ❑ **Probe head: Aluminium, stainless steel or plastic**
- ❑ **Stainless Steel Connection & Tube**
- ❑ **Stainless steel float - Ø 49 mm**
- ❑ **ALL STAINLESS STEEL version**

- ❑ **Mounting options - G2" connection**
 - **Clamp connection 2 1/2"**
 - **Flange DN65 PN10/16**
 - **Others: Contact us for details**

- ❑ **Length ≤ 2 meters**
- ❑ **Other lengths, please contact us!**

- ❑ **One to seven single contacts**
- ❑ **One or two changeover contacts.**

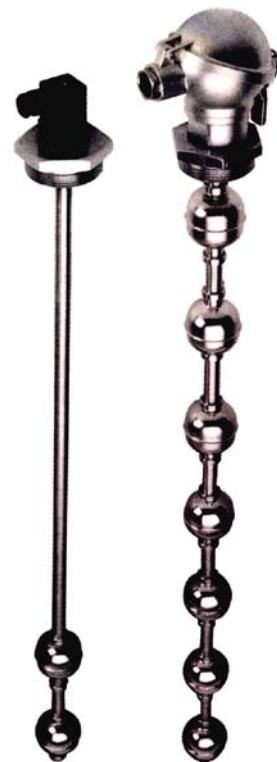

Functions & Introduction

See our **NF Manual**: Measurement & Float Level Switches.

Using a Contact Protection Relay is recommended - see **R2F2 manual**

Technical specifications*

Probe head	Hirschmann IP65 socket	2 contacts maximum	
	IP55 aluminium housing	7 contacts maximum	Independent or Common
	Stainless steel housing	7 contacts maximum	Independent or Common
Fixing & Tube	G2" connection	316L stainless steel	With 316L stainless steel guide tube
	Clamp connection 2 1/2"	316L stainless steel	With 316L stainless steel guide tube
	DIN flange DN65 PN10/16	316L stainless steel	With 316L stainless steel guide tube
Float	Material	Density	T° max
	316L stainless steel	≥ 0,8	-10° at 100°C
Electrical Contact	REED bulb / Switch with Flexible Leaf (ILS)		
	These contacts are optionally at "Open/Close" or "Changeover".		
	They are not bistable: Contact is maintained by the stops that block the float facing the REED bulb.		
	Standard	Single with Shared ILS	P.d.C. 40W/VA/400VAC/2A
Option	Single Independent ILS	P.d.C. 40 W/VA/400V AC/2A	
	ILS changeover	P.d.C. 20 W/VA/150V AC/1A	

* We remain at your disposal for any further information.

Subject to change without notice.

Probe heads (Dimensions in mm) & Wiring

DIAGRAM 1A	DIAGRAM 1B	DIAGRAM 1C
Hirschmann socket	Aluminium head	Stainless steel head
<p>SINGLE contact(s)</p>	<p>"SINGLE" contact(s)</p> <p>With Common</p> <p>Independent</p>	
<p>CHANGEOVER contact</p>	<p>Contact(s) "CHANGEOVER"</p>	
<p>Terminal ⊕: Ground</p> <p>Terminal 1: NF</p> <p>Terminal 2: NO</p> <p>Terminal 3: Common</p>		

Remarks

Please observe the contact breaking power (see Technical specifications)

Using a Contact Protection Relay is recommended - see our R2F2 manual.

Our contacts are not bistable. Contact is maintained by the stops that block the float facing the REED bulb.

Subject to change without notice.

Level Detection Sensor with Float

DF60	NF
Index E4	Page 3/4

Dimensions (in mm)

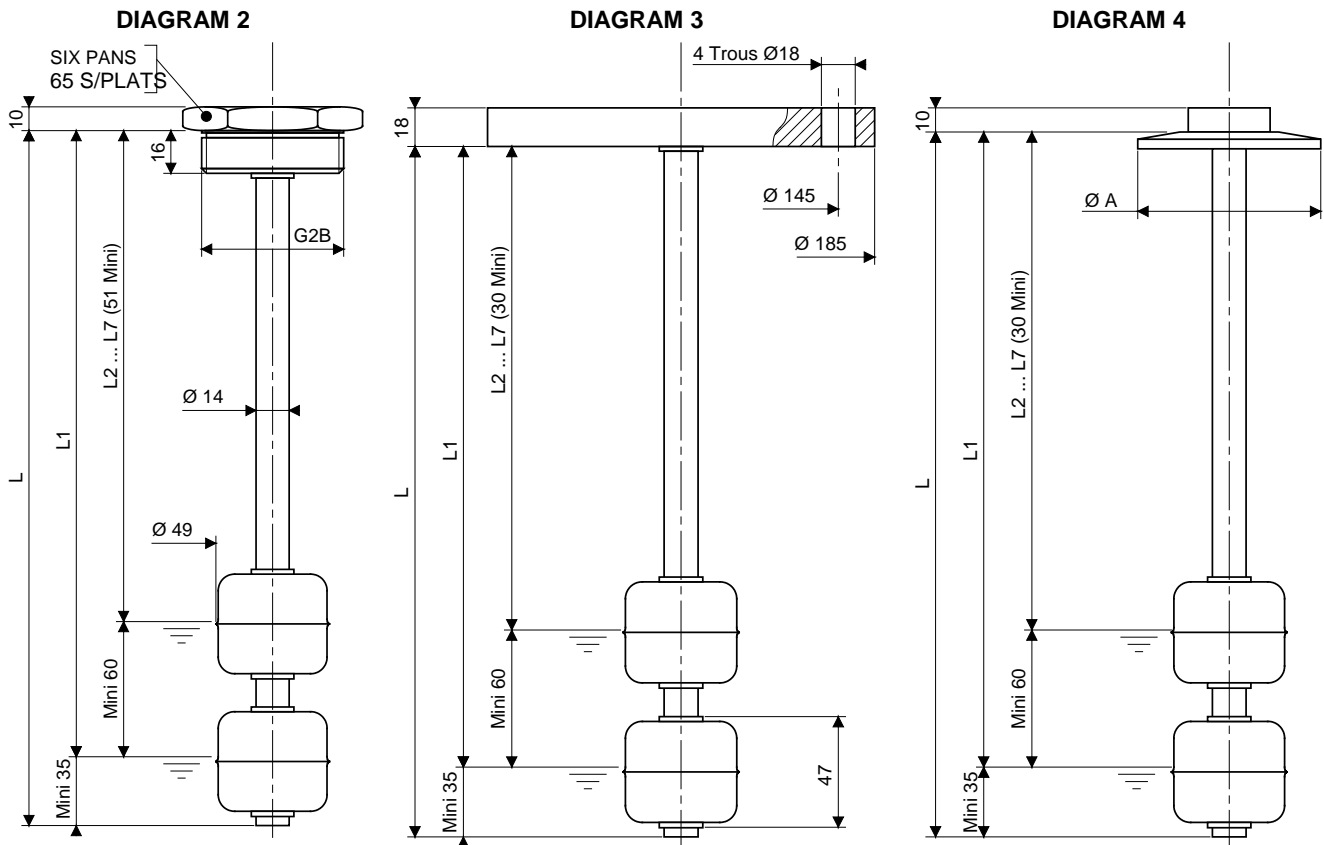

Installation

Upright on top of the tank.

The Standard connection (G2") allows the passage of the floats through the orifice.

However, it is possible to remove the floats by taking the stops out of the guide tube.

To change the nature of the contact (NO or NC), return the float. This may require the position of the stops to be adjusted:

- Contact **N**ormally **O**pen: Closing by rising level.
- Contact **N**ormally **C**losed: Closing by falling level.

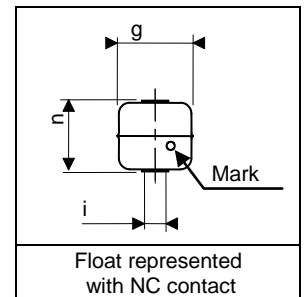

Subject to change without notice.

Level Detection Sensor with Float

DF60	NF
Index E4	Page 4/4

Your choice of probe

- Choose your part number in the **Tables below**.
- Set the Number of detection points, nature of the contact (NO or NC) and lengths L, L1, etc by completing the table below:

	L1	L2	L3	L4	L5	L6	L7
Contact nature ⁽¹⁾							
Length (in mm) ⁽²⁾							

(1) CHANGEOVER, NO or NC contact: See the **installation & Wiring** paragraphs.
 (2) Within the limits defined in the **Dimensions** section on pages 3/4

- Set Total Guide Tube Length - Length L = _____ mm ($L \leq 2,000$ mm and $L \geq L1+35$ mm).

Reference tables

Probe head		Mounting and Guide Tube		Dimensions		Item code	
Type	Contacts	Fixing	Material	Head	Probe	Former	Equivalence
Socket Hirschmann IP65	Max. 2	G2" connection	316L SS	Diagram 1A	Diagram 2	DF0771LSFC	DF603H 03 XN1
		Flange DN65 PN10	316L SS	Diagram 1A	Diagram 3	DF0771LSDN	DF603H 52 XN1
		2 1/2" clamp	316L SS	Diagram 1A	Diagram 4	/	DF603H 30 XN1
Housing Aluminium IP55	Max. 7	G2" connection	316L SS	Diagram 1B	Diagram 2	DF0772LSFC	DF603A 03 XN1
		Flange DN65 PN10	316L SS	Diagram 1B	Diagram 3	DF0772LSDN	DF603A 52 XN1
		2 1/2" clamp	316L SS	Diagram 1B	Diagram 4	/	DF603A 30 XN1
Housing STAINLESS STEEL IP65	Max. 7	G2" connection	316L SS	Diagram 1C	Diagram 2	DF0772TXFC	DF603X 03 XN1
		Flange DN65 PN10	316L SS	Diagram 1C	Diagram 3	DF0772TXDN	DF603X 52 XN1
		2 1/2" clamp	316L SS	Diagram 1C	Diagram 4	/	DF603X 30 XN1

		DF						
Float diameter	Ø 52, stainless steel		6	0	3			
Probe head	Aluminium housing					A		
	Hirschmann socket					H		
	Stainless steel head					X		
Connection	G2 stainless steel connection					0	3	
	Clamp connection (2 1/2")					3	0	
	Stainless steel flange DN65					5	2	
Guide tube	Bare stainless steel						X	
Contact(s) Type and Number	With Common	One					N 1	
		Two					N 2	
		Three					N 3	
		Four					N 4	
		Five					N 5	
		Six					N 6	
		Seven					N 7	
	Independent	Two						D 1
		Three						D 2
	Changeover	One						V 1
		Two						V 2

Subject to change without notice.

